

**SPECIFICATIONS:**

- MODEL NUMBER:** 8000-853-238
- PUMP DESIGN:** Positive Displacement 3 Chamber Diaphragm Pump
- CHECK VALVE:** (2-Way Op.) Prevents Reverse Flow & 6 Ft. Head Forward Flow
- CAM:** 3.0 Degree
- MOTOR:** Permanent Magnet, P/N 11-127-10
- VOLTAGE:** 24 VDC Nominal
- PRESSURE SWITCH:** Adjustable Shut-Off (Range 80-100 PSI)  
 Factory Set @100 PSI, Turn On 85 PSI ±5 PSI
- LIQUID TEMPERATURE:** 180 Degrees Fahrenheit (82 Degrees Centigrade) Max.
- PRIME:** Self-Priming Up To 8 Ft. Vertical,  
 Max. Inlet Pressure 30 PSI (2.1 Bar)
- PORTS:** 3/8"-18 NPT Female
- MATERIAL OF CONSTRUCTION:**
  - PLASTICS-** Nylon
  - VALVES-** Viton
  - DIAPHRAGM-** Santoprene
  - FASTENERS-** Zinc Plated Steel
- NET WEIGHT:** 4.7 Lbs (2.13 Kg)
- DUTY CYCLE:** Intermittent (See Temperature Rise Chart)
- TYPICAL APPLICATIONS:** Soil Extraction

**DIMENSIONS:**

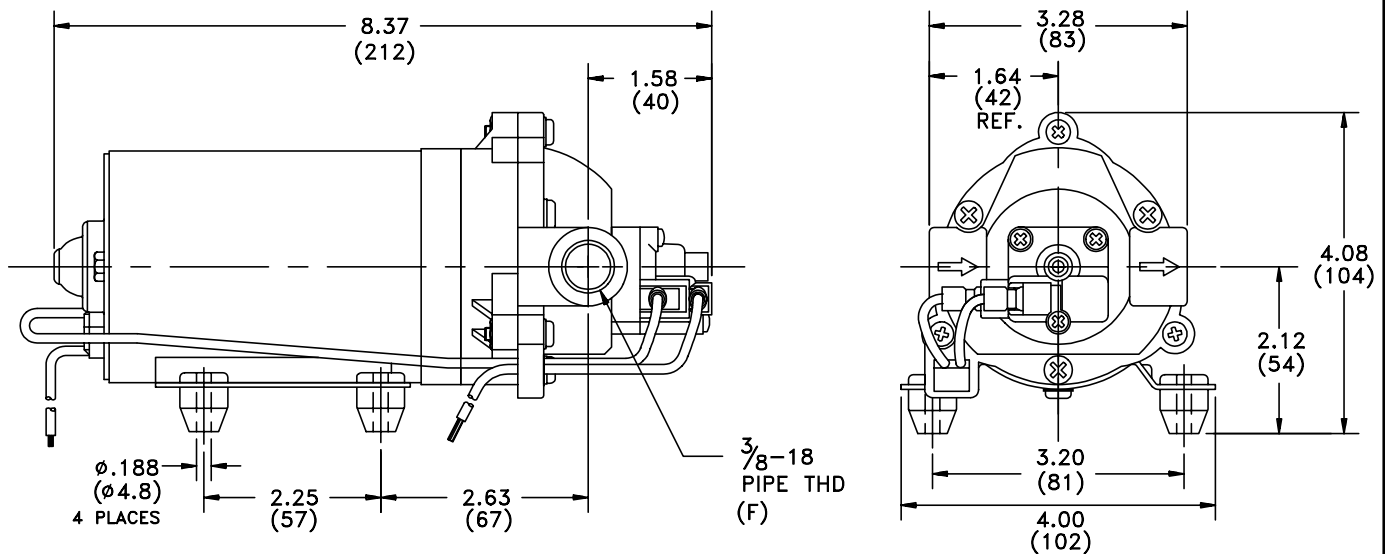

**TEMPERATURE RISE**

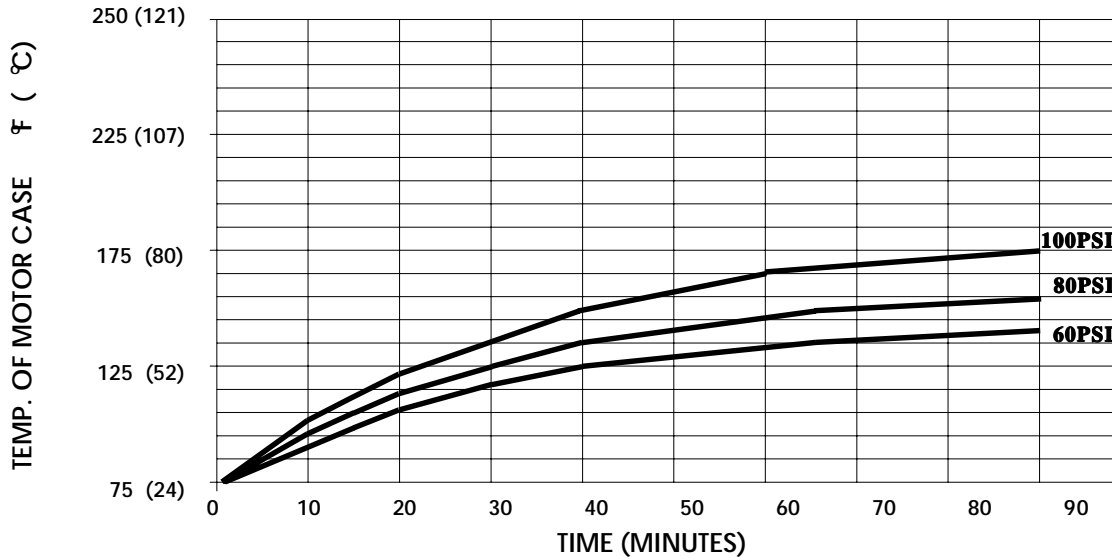

THIS GRAPH IS FOR USE AS A DESIGN GUIDE. IT IS BASED ON RUNNING CONTINUOUSLY WITH AN AMBIENT TEMPERATURE OF 70° F IN STILL AIR.

**TYPICAL PERFORMANCE**

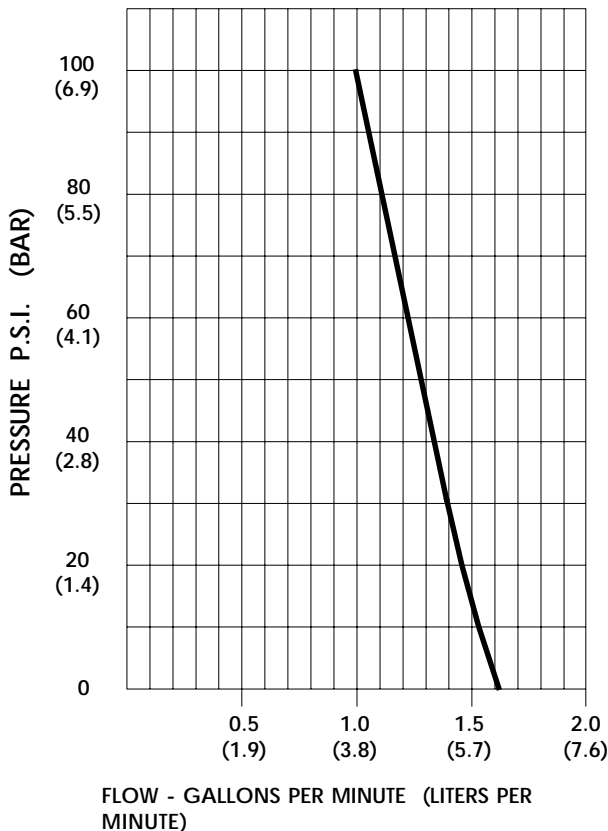

PRESSURE (PSI)	FLOW (GPM/LIT)	RPM MIN/MAX	CURRENT (AMPS)	VOLTAGE (VOLTS)
OPEN	<b>1.61/6.1</b>	<b>2305/2320</b>	<b>1.8</b>	<b>24VDC</b>
10	<b>1.54/5.8</b>	<b>2280/2295</b>	<b>2.1</b>	"
20	<b>1.46/5.5</b>	<b>2240/2265</b>	<b>2.4</b>	"
30	<b>1.38/5.2</b>	<b>2200/2240</b>	<b>2.7</b>	"
40	<b>1.33/5.0</b>	<b>2145/2218</b>	<b>3.0</b>	"
50	<b>1.26/4.8</b>	<b>2115/2190</b>	<b>3.3</b>	"
60	<b>1.22/4.6</b>	<b>2090/2160</b>	<b>3.5</b>	"
70	<b>1.17/4.4</b>	<b>2065/2132</b>	<b>3.8</b>	"
80	<b>1.12/4.2</b>	<b>2030/2110</b>	<b>4.1</b>	"
90	<b>1.06/4.0</b>	<b>2000/2080</b>	<b>4.3</b>	"
100	<b>1.02/3.9</b>	<b>1970/2050</b>	<b>4.5</b>	"

*-SPECIFICATIONS SUBJECT TO CHANGE WITHOUT NOTICE.*

*-ALL DATA BASED ON TESTING WITH WATER AT AMBIENT TEMPERATURE.*